

1631 15th Avenue West | Seattle, Washington 98119

www.interbayworklofts.com



AVAILABLE SUITES RANGE FROM 1,000 SF TO 2,061 SF

Located in Interbay with easy access to Queen Anne, Magnolia, Fremont and Ballard. Each suite is designed to allow for efficiency, comfort and flexibility.

HIGHLIGHTS

Light filled spaces with large, operable windows

Full kitchen and restroom with shower

Washer and dryer in each suite

Each suite is private and individually keyed

Outdoor courtyard with tables, seating and a BBQ

Wi-Fi/internet hook ups

Self-contained HVAC unit in each suite

Several large shared conference rooms

Large community kitchen/entertaining area

Underground parking

Onsite gym

24/7 access

Competitive lease rates and flexible terms

Pet friendly environment



NEWMARK

TRACY TURNURE
+ 1.425.372.9923
tracy.turnure@nmrk.com

CAVAN O'KEEFE
+ 1.206.395.2903
cavan.okeefe@nmrk.com



1631 15th Avenue West | Seattle, Washington 98119

www.interbayworklofts.com



LOCATION

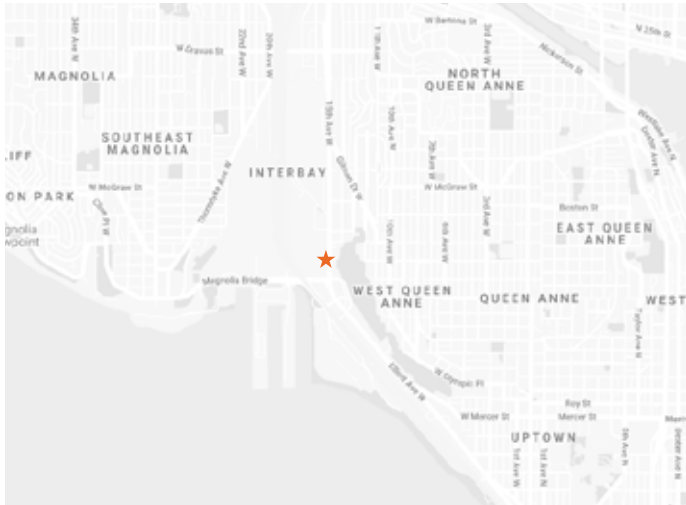

AVAILABILITIES

| | |
|---------|-------------------------------|
| Floor 1 | 1,024 - 1,163 SF |
| Floor 2 | 1,000 - 2,061 SF (combinable) |
| Floor 3 | 1,000 - 2,000 SF (combinable) |



NEWMARK

TRACY TURNURE
Associate
+ 1.425.372.9923
tracy.turnure@nmrk.com

CAVAN O'KEEFE
Senior Managing Director
+ 1.206.395.2903
cavan.okeefe@nmrk.com

Procuring broker shall only be entitled to a commission, calculated in accordance with the rates approved by our principal only if such procuring broker executes a brokerage agreement acceptable to us and our principal and the conditions as set forth in the brokerage agreement are fully and unconditionally satisfied. Although all information furnished regarding property for sale, rental, or financing is from sources deemed reliable, such information has not been verified and no express representation is made nor is any to be implied as to the accuracy thereof and it is submitted subject to errors, omissions, change of price, rental or other conditions, prior sale, lease or financing, or withdrawal without notice and to any special conditions imposed by our principal. 10200 North Lombard, LLC has a binding contract to purchase the property and authorization from Seller to market the property for lease, pursuant to that agreement Buyer discloses that: a) Buyer does not currently own the Property, (b) no rights of use or occupancy shall arise unless and until Buyer acquires title to the Property and (c) no agreement between Buyer and any prospective tenant shall be binding upon Seller or the Property. JEG110916

FLOOR 1

| Suite | | Size |
|-----------|---|----------|
| Suite 114 |  | 1,024 SF |
| Suite 116 | | 1,037 SF |
| Suite 120 |  | 1,163 SF |



FLOOR 2

| Suite | Size | Suite | Size | Combinable Suites | Size |
|---------------|----------|---------------|----------|-------------------|----------|
| Suite 206 | 1,000 SF | Suite 215 | 1,037 SF | Suites 207/208 | 2,000 SF |
| Suite 207/208 | 2,000 SF | Suite 216 | 1,037 SF | Suites 214/215 | 2,061 SF |
| Suite 212 | 1,000 SF | Suite 217/218 | 1,800 SF | Suites 217/218 | 1,800 SF |
| Suite 214 | 1,024 SF | | | | |



FLOOR 3

| Suite | Size | Suite | Size | Combinable Suites | Size |
|-----------|----------|-----------|----------|-------------------|----------|
| Suite 305 | 1,165 SF | Suite 321 | 1,062 SF | Suites 306/307 | 2,000 SF |
| Suite 306 | 1,000 SF | | | | |
| Suite 307 | 1,000 SF | | | | |
| Suite 315 | 1,037 SF | | | | |

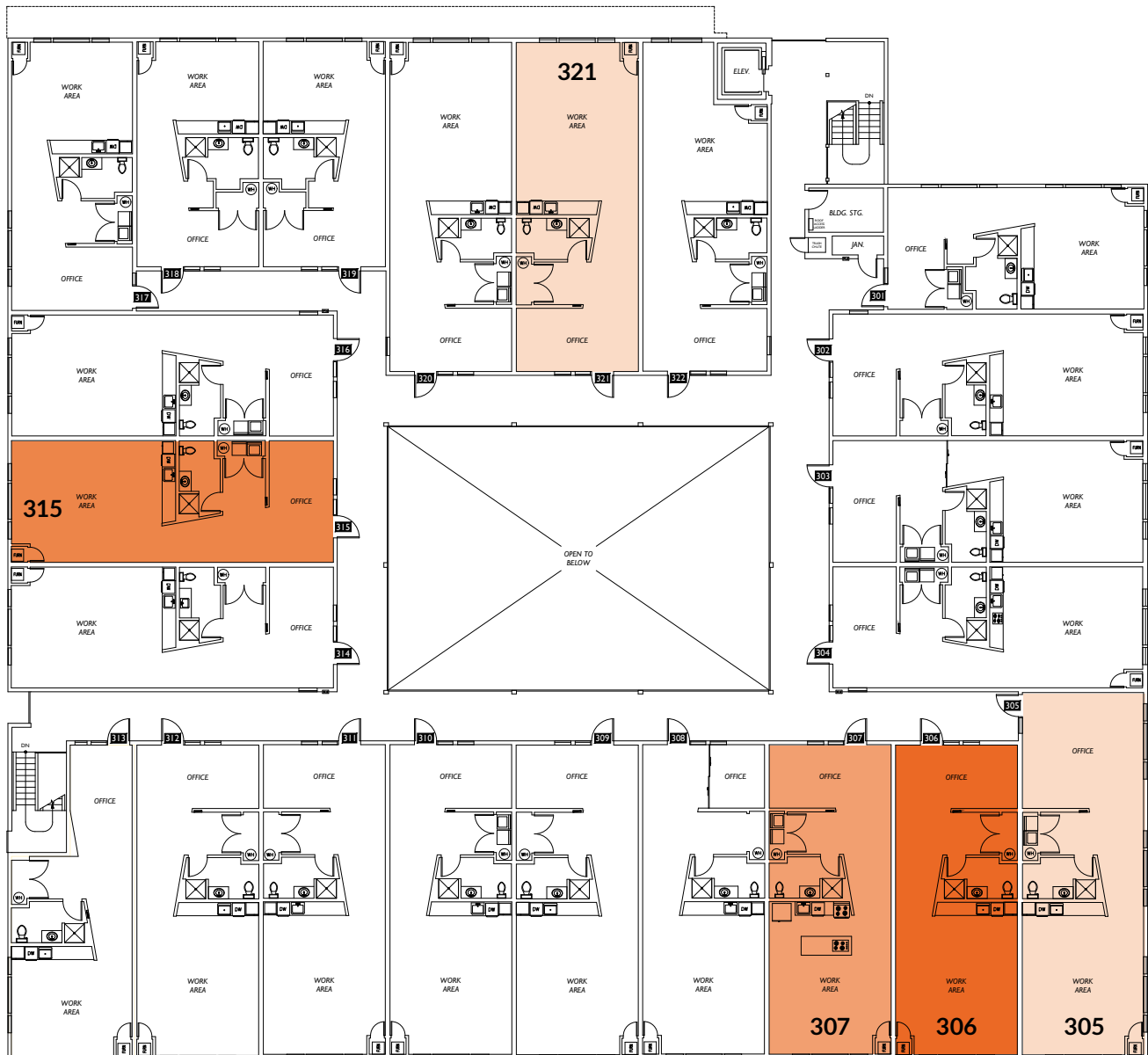

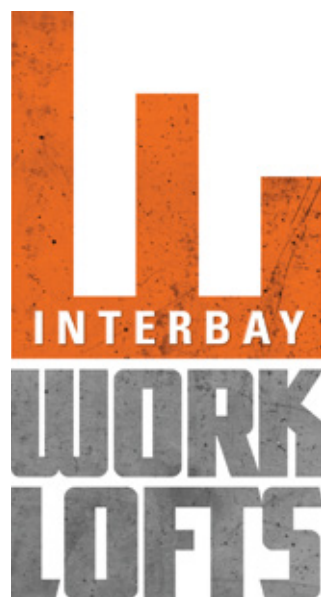

NEWMARK

TRACY TURNURE
+ 1.425.372.9923
tracy.turnure@nmrk.com

CAVAN O'KEEFE
+ 1.206.395.2903
cavan.okeefe@nmrk.com